

PRINTABLE INFO SHEET

Series: Cambridge 2 Ranch
Collection
Model: HH303A Sandalwood

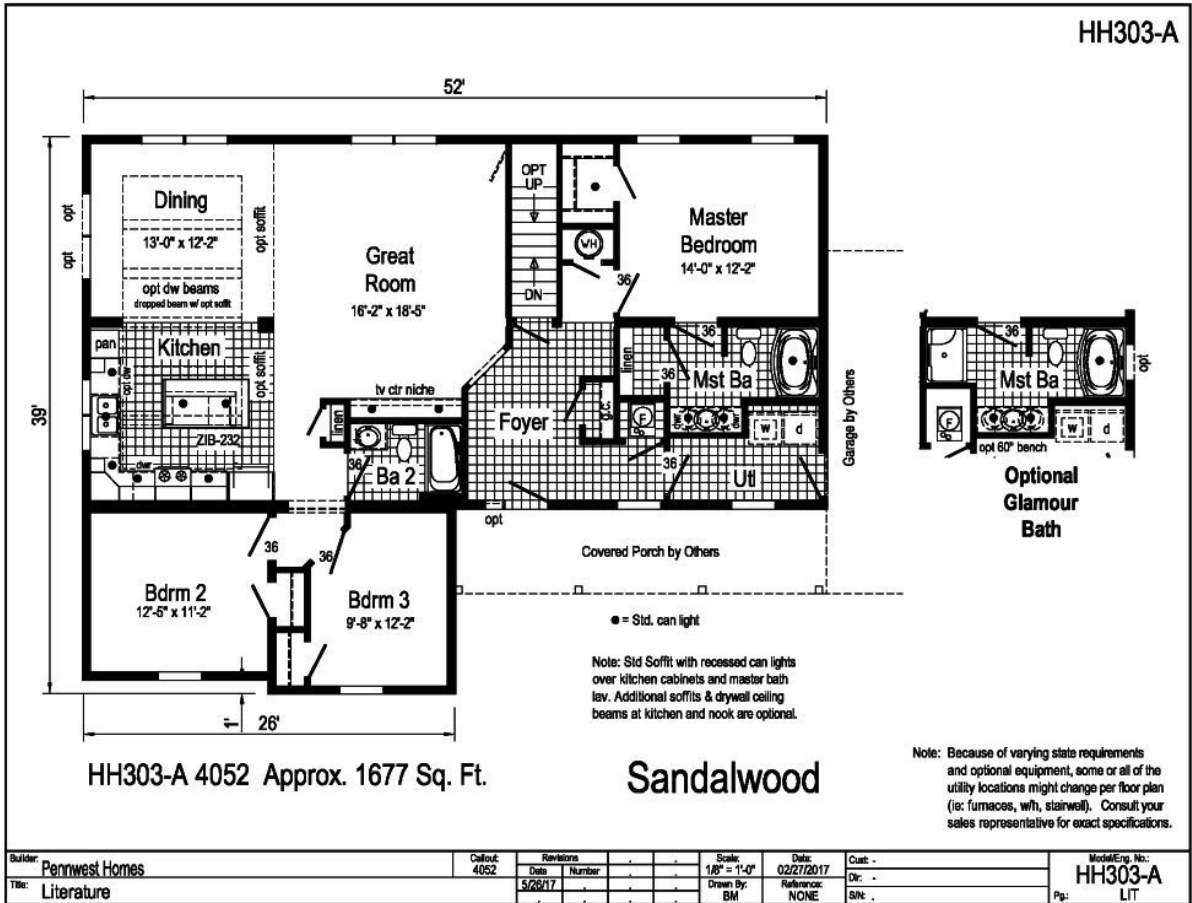

About This Model

Style: Ranch / Bedrooms: 3 / Bathrooms: 2 / Square Feet: 1677

CUSTOMER CONTACT

Notes:

PRINTABLE INFO SHEET

**Series: Cambridge 2 Ranch
Collection
Model: HH303A Sandalwood**



Standards & Features

HOME COMPONENTS

- Complete Water Lines Supplied
- Complete Electrical
- Drain and Gas Lines Stubbed Through Floor
- Complete Heat System
- Complete Air Return System

INTERIOR

- Primed Drywall Throughout
- Smooth Flat Ceiling Throughout
- 8'0" Ceiling Height
- Mantra or It's Cozy Carpet
- Rebond Carpet Pad
- Tackstrip Carpet Installation
- Foyer Entry with Vinyl Flooring
- No-Wax Vinyl Floor Coverings by Congoleum
- Brushed Nickel Pendant Dining Room Light
- 2 Recessed LED Lights in Nook
- 36" Doors - where available
- Pre-Hung Doors with Mortise Hinges
- Metal Interior Passage Sets
- Smoke Detectors with Battery Back-Up
- Wire Shelving in Guest Closet
- White Painted Pine Moldings Throughout

White 6-Panel

KITCHEN

Tip-Out Trays at Sink

KITCHEN (continued)

- Stainless Steel Sink-33x22x8
- Huntington Brass Brushed Nickel Single Lever Faucet
- Power Range Hood with Light
- 30" Deluxe Gas Range
- 18 Cu. Ft. Frost Free Refrigerator
- 1 USB Receptacle
- Sweep-O-Vac in Island or Base Cabinet

CABINETRY

- Evermore Custom Cabinetry (KCMA Certified)
- Choice of Oak or Barnwood Oak 3/4 Overlay

Mission Flat

- Panel Cabinet Doors
- Hardwood Oak Cabinet Face Frames
- Upgrade Cabinet Hardware
- Hidden Cabinet Hinges
- 30" Wall Cabinets with 6" Wood Trim & Crown
- 6" x 27" Soffit with 5 Recessed LED Lights Above Cab.
- Adjustable Shelves in Overhead Cabinets
- Drawer-Over-Door Base Cabinets
- 100# Undermount Drawer Guides
- Base and Center Shelves in Base Cabinets
- Dovetail Drawer Construction
- Laminate Countertops with Laminate Edging

CUSTOMER CONTACT

Notes:

PRINTABLE INFO SHEET

**Series: Cambridge 2 Ranch
Collection
Model: HH303A Sandalwood**



Standards & Features (continued)

CABINETRY (continued)

4" Laminate Backsplash
Kitchen Island ‐ Where Available
36" High Vanities

BATHS

Curved Front Garden Tub in Master
Bath - Where Available
Tub Overflows
Recessed LED Light over Tub in
Master Bath
Elongated Toilets
China Sinks with Overflows and
Pop-Up Drains
Lighted Vent Fan in Each Bath
Soffit over Master Vanity with Recessed LED Lights
Huntington Brass Brushed Nickel Faucets
Anti-Scald Valves on Showers and Tubs
Linens - Where Available

UTILITIES

200 AMP Electrical Service
Plumb and Wire for Washer
Wire for Dryer
Programmable Thermostat with
8-Wires
Main Water Line Shut-Off Valve
Water Shut-Off Valves where
Accessible
One Exterior Water Faucet
50 Gallon Electric Water Heater with Pan
Energy Efficient 90 Plus Gas Furnace
Perimeter Heat System with Fiberglass

UTILITIES (continued)

Heat Ducts

BEDROOMS

Switched Recepts
Egress Window Each Bedroom
Wire Shelving in Wardrobes
Switched 4" Recessed LED Light

in All Walk-In

Closets

INSULATION

R-19 Fiberglass Insulation in Walls
R-38 Avg. Batt Insulation in Ceiling

EXTERIOR

Pantina Lantern Light at Front and Rear Door
Two GFI-Protected Exterior Receptacles
Vinyl Ship Lap Siding
O.S.B. Sheathing Under Siding
Wind Wrap Air Infiltration Barrier
5/12 Pitch Roof with 12" Eaves and Overhangs
Architectural Shingles
Ridgevent Roof Ventilation System
Ice Shield
3/0 x 6/8 Pre-Finished 6-Panel Rear
Door with Deadbolt Locks
Painted 6-Panel Front Door in Choice
of Color with Deadbolt Locks
Vinyl Insulated Argon Filled Windows with Low-E Glass (No
Grids)
Lineals on Front Door Side

CONSTRUCTION

2x10 Transverse Floor System on

CUSTOMER CONTACT

Notes:

PRINTABLE INFO SHEET

**Series: Cambridge 2 Ranch
Collection
Model: HH303A Sandalwood**



Standards & Features (continued)

CONSTRUCTION (continued)

16" Centers with 23/32" OSB T&G

Floor Decking**

2x6 Exterior Walls on 16" Centers**

2x4 Interior Walls

90 Mile Exposure C Wind Load Design

40# Roof Load Design

**NOTE: Spacing for Framing Members may vary due to Design Requirements

CUSTOMER CONTACT

Notes:
